

March 28th - May 3rd 2014

Joan Dark

Carole Itter

Tiziana La Melia

Li Liao

Ariana Reines

Bunny Rogers

Walter Scott

List of Works

Front room:

1. Carole Itter

Raw Egg Costume, 1974

Set of two photographs, each 16 x 24 in

Photo credit: Taki Bluesinger

2. Tiziana La Melia

Aquarium club console (janis), 2014

steel table, glass, film, latex paint

Dimensions variable

3. Tiziana La Melia

Writing the black fruits, 2014

Oil on panel, 22 x 33 in

4. Tiziana La Melia

Holding on to the part, 2014

Oil on panel, 24 ¾ x 41 ½ in

5. Carole Itter

Barnyard Stories, 1972

Lino stamps on paper

Stamps hand carved by Michael Henry

65 pages, a page turned each day

Courtesy of the Strathcona Art Gallery

6. Tiziana La Melia

Turtle neck, 2014

Oil on panel, 22 x 33 in

7. Ariana Reines

Hel, 2014

Object purchased at Forever 21

& subsequently destroyed

Dimensions variable

Back room:

8. Walter Scott

Chapter 2: Katniss Everdeen's West Coast Odyssey, 2014

wood, acrylic, string, vinyl, jersey, human

hair, reflective tape

Dimensions variable

9. Tiziana La Melia

Class room (private eyes), 2013

Gouache on linen, 27 x 44 in

10. Ariana Reines

FOREVER 21, 2014

Ink on newsprint

Edition of 850, 14 x 19 in

11. Li Liao

Sierra Door Safety Rules, 2012

Single channel digital video of

performance

2 min 48 sec

12. Walter Scott

Epilogue: Winona's Return (Saturn, And Her Father), 2014

wood, acrylic, vinyl, jersey, human hair,

reflective tape

Dimensions variable

13. Bunny Rogers

Clone State Chairs (Version A), 2014

Maple, faux suede, wool, hardware, wood

ash

Dimensions variable

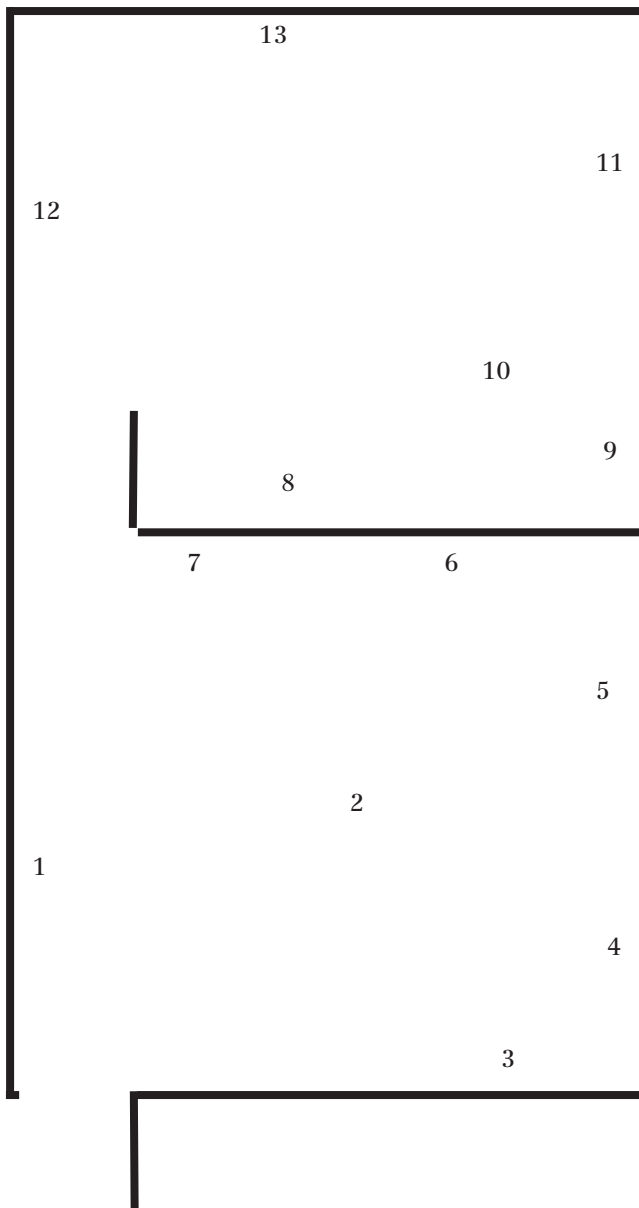

Taking its title from the lead character in Bertolt Brecht's 1932 play *Saint Joan of the Stockyards*, *Joan Dark* evokes theatrical structures to navigate the slippage between objects and language. With an emphasis on the role of writing within the exhibition space, *Joan Dark* presents the works of six artists that plot the dialectic of the utilitarian and the lyrical. *Joan Dark* can be seen as both a title and a character; a reified individual whose agency and identity is both fixed and malleable.

Set design by Tiziana La Melia with Julian Hou and Jesse Birch.

With special thanks to the Charles H. Scott Gallery and the Strathcona Art Gallery.